

C-82-180

Geo: Henry

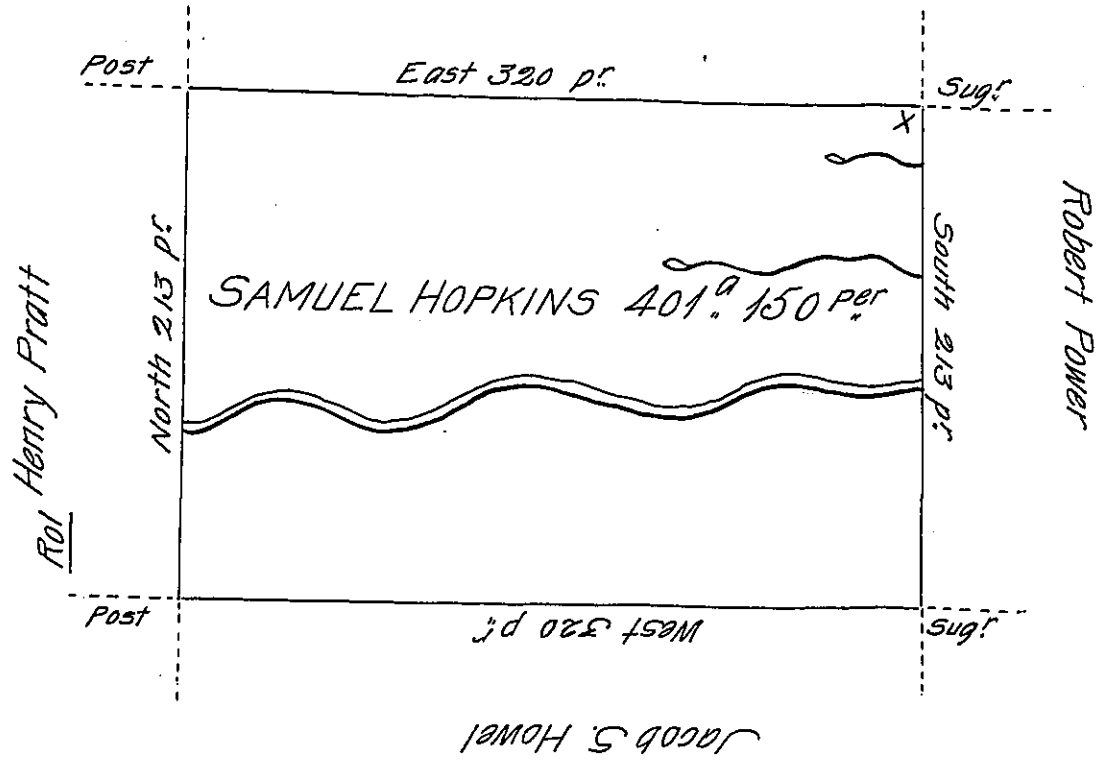

Situate on the West side of French Creek in Allegheny County containing 401 Acres
 and 150 perches & All^{ce} of Six P Cent for Roads &c. Surveyed the 11th day
 of May 1795 In pursuance of a B Warrant dated the 30th day of May 1792.

W^m Power D.Y.S^r

To Daniel Brodhead Esq^r }
 Surveyor General

IN TESTIMONY that the above is a copy of the original remaining on file in
 the Department of Internal Affairs of Pennsylvania, made
 conformably to an Act of Assembly approved the 16th day of
 February, 1833, I have hereunto set my Hand and caused
 the Seal of said Department to be affixed at Harrisburg,
 this second day of February 1905.

Loac R. Brown
 Secretary of Internal Affairs.